

SKETCH SHOWING EXISTING CONDITIONS OVER
 PART OF LOT 2 (FRONTING ON JAMES STREET)
 PART OF LOTS 2 AND 3 (FRONTING ON HUGHSON STREET)
 JAMES HUGHSON SURVEY
 UNREGISTERED
 IN THE BLOCK BOUNDED BY JAMES, CANNON HUGHSON AND WILSON STREETS
 IN THE
CITY OF HAMILTON
 SCALE 1:200
 0 5 10 metres
 G. G. ALDORTH O.L.S.

CANNON STREET EAST

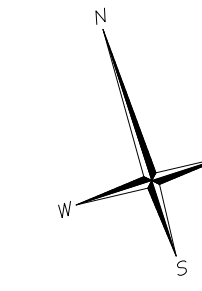

JAMES STREET NORTH

HUGHSON STREET NORTH

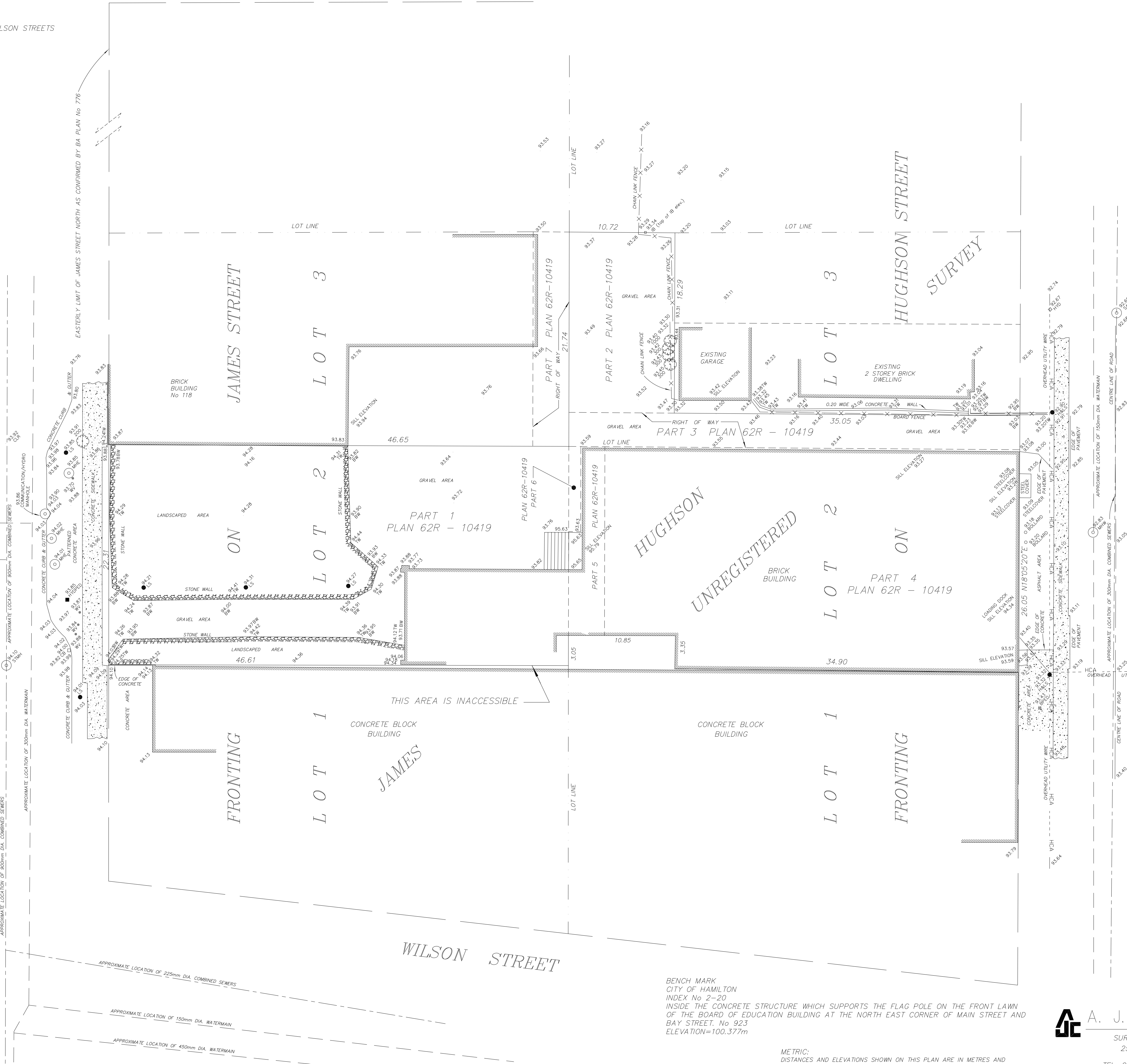

- LEGEND:**
- BPED DENOTES BELL PEDESTAL
 - BW DENOTES BOTTOM OF WALL
 - CB DENOTES CATCH BASIN
 - CLP DENOTES CENTRE LINE OF ROAD
 - H&LS DENOTES HYDRO & LIGHT STANDARD
 - HYD DENOTES FIRE HYDRANT
 - HYDPED DENOTES HYDRANT PEDESTAL
 - LS DENOTES LIGHT STANDARD
 - MHE DENOTES ELECTRICAL MANHOLE
 - MHW DENOTES WATER MANHOLE
 - SAMH DENOTES SANITARY MANHOLE
 - STMH DENOTES STORM MANHOLE
 - TW DENOTES TOP OF WALL
 - WV DENOTES WATER VALVE
 - Z00 DENOTES 200mm DIA. TREE

APRIL 28, 2011
 DATE

© COPYRIGHT, 2011 A. J. CLARKE & ASSOCIATES LTD.
 THE REPRODUCTION, ALTERATION OR USE OF THIS REPORT,
 IN WHOLE OR IN PART, WITHOUT THE EXPRESS PERMISSION OF
 A. J. CLARKE & ASSOCIATES LTD. IS STRICTLY PROHIBITED.

BENCH MARK
 CITY OF HAMILTON
 INDEX No 2-20
 INSIDE THE CONCRETE STRUCTURE WHICH SUPPORTS THE FLAG POLE ON THE FRONT LAWN
 OF THE BOARD OF EDUCATION BUILDING AT THE NORTH EAST CORNER OF MAIN STREET AND
 BAY STREET, No 923
 ELEVATION=100.377m

METRIC:
 DISTANCES AND ELEVATIONS SHOWN ON THIS PLAN ARE IN METRES AND
 CAN BE CONVERTED TO FEET BY DIVIDING BY 0.3048

A. J. Clarke and Associates
 SURVEYORS • PLANNERS • ENGINEERS
 25 MAIN STREET WEST, SUITE 300
 HAMILTON, ONTARIO, L8P 1H1
 TEL. 905-528-8761 FAX 905-528-2289
 email: ajc@ajclarke.com

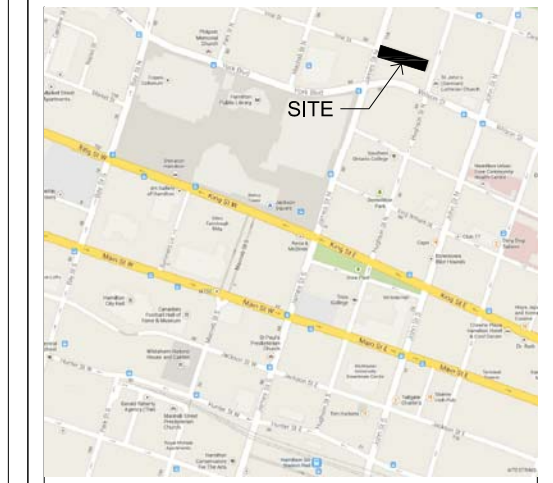
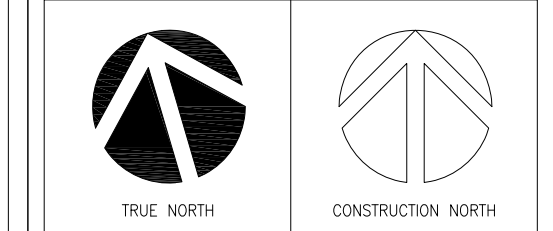

ISSUE NO.	REV. NO.	DESCRIPTION	DATE
1		ISSUED FOR PRELIM. SPA	14.04.22

REVISIONS:
 DISCREPANCIES MUST BE REPORTED IMMEDIATELY TO THE ARCHITECT BEFORE PROCEEDING. ONLY FIGURED DIMENSIONS MUST BE USED. THE CONTRACTOR MUST CHECK THE DIMENSIONS ON SITE.
 THE DRAWING IS PROTECTED BY COPYRIGHT. ALL DIMENSIONS ARE SHOWN IN MILLIMETERS.
 DO NOT SCALE THE DRAWINGS.

MSA
 Making Sustainable Architecture
 McCallum Sather Architects Inc.
 157 Catherine St. N. Hamilton, ON L8L 4E4
 T 905.528.6700 W www.msa.ca

SEAL
 CONSULTANTS:

PROJECT:
Tivoli Condos

108 James Street N
 Hamilton, ON

DRAWING TITLE:
EXISTING SURVEY

DRAWN BY: **CK** DATE: **14.02.03**
 CHECKED BY: **DH** SCALE: **NTS**

PROJECT NO: **13004**
 DRAWING NO: **AA300**

FILED: Tivoli, April 22, 2014, 3:45:08 PM

T-2071

H:\Users\T-10-2\UNREG\HMS\ACAD\HW\LOT02\Apr_19_2011_Tivoli\T-2071.dwg